

A project by



LIFE
EMPOWERED...



SATYA
**GREEN
TOWERS**

A graphic element for the Green Towers logo, consisting of several vertical brown lines of varying heights, with a green vine-like element climbing up the right side.

Near CTO Office, Vizianagaram

RERA No: P02280160693
www.satyabuilders.in

DISCOVER
A PAMPERING
LIFESTYLE





2 MINUTES TO EVERYWHERE...

Life is all about making good choices. Choose to live in a central location and enjoy its advantages. Get pampered with an active lifestyle where the world is within your reach. Choose joy and freedom with an apartment at **Satya Green Towers**.

Elite schools, mall shopping, fine dining and multiplex movies are located just a few minutes away from home. Feel the power of an address where housewives, children and senior citizens have access to everything at a walking distance. Simply, life will be a celebration at centrally located **Satya Green Towers**.

SATYA
**GREEN
TOWERS**

The logo graphic consists of a vertical stack of brown rectangular bars of varying heights, resembling a stylized building or a tree trunk. A green vine with leaves is wrapped around the right side of these bars.





EMPOWERED BY DESIGN...

The five-floor, 3 block **Satya Green Towers** is a triumph of design integrating natural elements with built spaces. Discover a world of comfort and convenience in 2 & 3 BHK apartments that take quality living to next level. Designed by leading architects and built by experienced promoters, the towers showcase the finest space planning that blend sunshine and breeze in sophisticated spaces. While each family member has his or her niche space, large living room and dining room foster family bonding. Live more life at **Satya Green Towers** than at any place.

SATYA
**GREEN
TOWERS**





PROJECT HIGHLIGHTS

- VMRDA - Approved Luxury Project
- 3 Blocks, Five floors Each
- 85 Two & Three BHK Apartments
- 1000 Sft - 2175 Sft Areas
- 100% Vastu
- No Common Walls
- Central Location
- Stilt Level Parking
- 24-Hr Professional Security with CC Cameras
- Intercom in each Unit
- Designer Landscaping
- High-end Specifications
- 24-Hr Water Supply
- 100% Power Back-up



EMPOWERED BY ENVIRONMENT...

The caring nuances begin with the majestic entrance gate. Give your children a secure environment and dust-free play areas to let loose. Senior citizens have quiet nooks to interact. The landscape design encourages community to spend quality time in outdoors. Ambient lighting, seating areas, 24-hr security give you peace of mind in a home that's just a few minute walk from royal centre of Vizianagaram city.

SATYA
GREEN TOWERS

SATYA
**GREEN
TOWERS**

BLOCK - A



FLAT NO. 101 to 501	SFT	SQM
CARPET AREA	1029.62	95.69
PLINTH AREA	1127	104.74
SUPER BUILT-UP AREA	1410	131.04

FLAT NO. 102 to 502	SFT	SQM
CARPET AREA	983.25	91.38
PLINTH AREA	1122	104.28
SUPER BUILT-UP AREA	1410	131.04

FLAT NO. 103 to 503	SFT	SQM
CARPET AREA	982.93	91.35
PLINTH AREA	1122	104.28
SUPER BUILT-UP AREA	1410	131.04

FLAT NO. 104 to 504	SFT	SQM
CARPET AREA	987.55	91.78
PLINTH AREA	1127	104.74
SUPER BUILT-UP AREA	1410	131.04



FLAT NO. 108 to 508	SFT	SQM
CARPET AREA	1051.81	97.76
PLINTH AREA	1127	104.74
SUPER BUILT-UP AREA	1410	131.04

FLAT NO. 107 to 507	SFT	SQM
CARPET AREA	938.81	87.25
PLINTH AREA	1054	97.96
SUPER BUILT-UP AREA	1325	123.14

FLAT NO. 106 to 506	SFT	SQM
CARPET AREA	943.11	87.65
PLINTH AREA	1054	97.96
SUPER BUILT-UP AREA	1325	123.14

FLAT NO. 105 to 505	SFT	SQM
CARPET AREA	1012.19	94.07
PLINTH AREA	1127	104.74
SUPER BUILT-UP AREA	1410	131.04



FLAT NO. 109 to 509	SFT	SQM
CARPET AREA	1057.60	98.29
PLINTH AREA	1131	105.11
SUPER BUILT-UP AREA	1410	131.04

FLAT NO. 110 to 510	SFT	SQM
CARPET AREA	743.62	69.11
PLINTH AREA	798	74.16
SUPER BUILT-UP AREA	1000	92.94

FLAT NO. 111 to 511	SFT	SQM
CARPET AREA	734.15	68.23
PLINTH AREA	798	74.16
SUPER BUILT-UP AREA	1000	92.94

FLAT NO. 112 to 512	SFT	SQM
CARPET AREA	1068.11	99.27
PLINTH AREA	1131	105.11
SUPER BUILT-UP AREA	1410	131.04

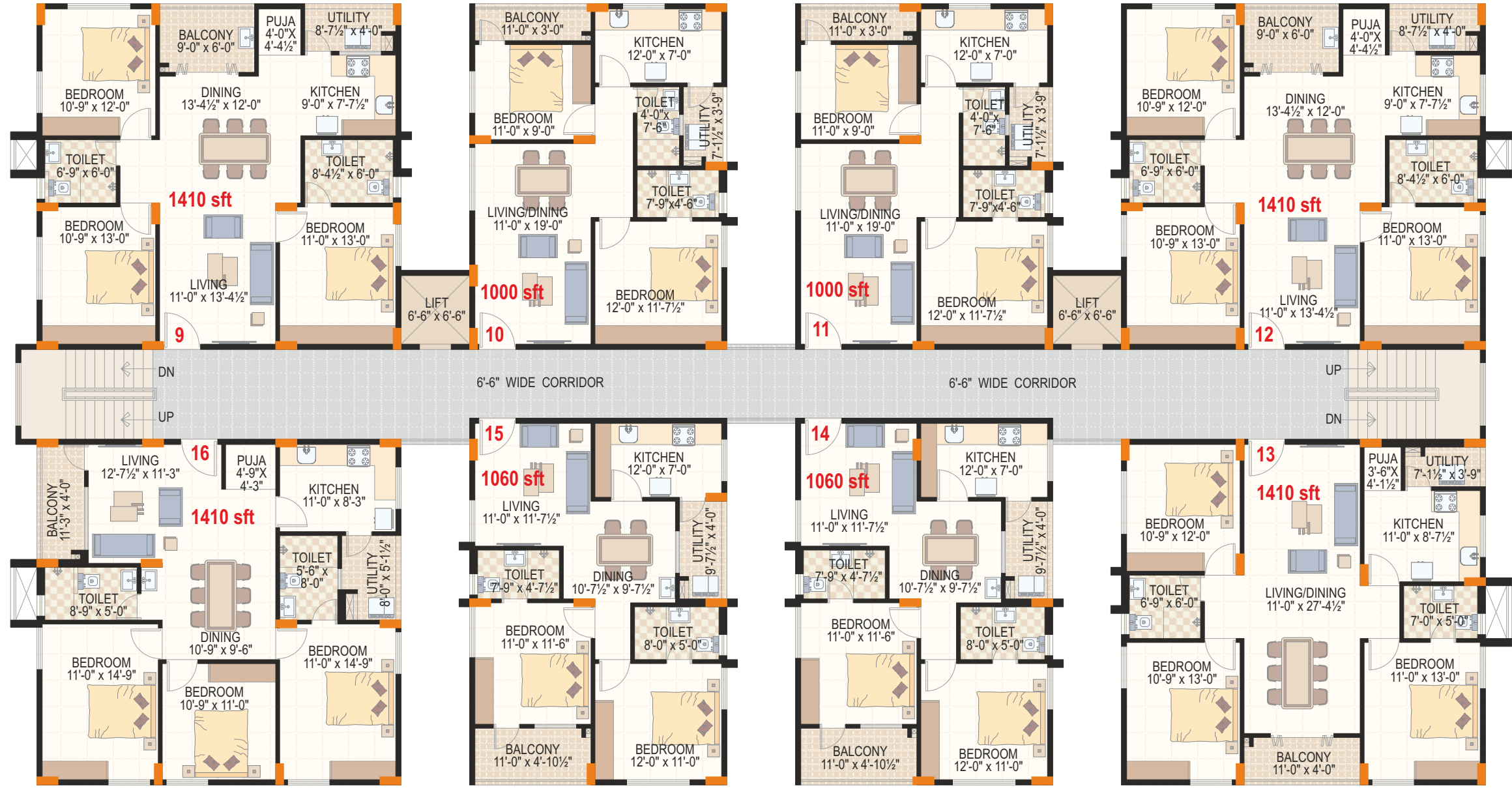

FLAT NO. 116 to 516	SFT	SQM
CARPET AREA	1008.75	93.75
PLINTH AREA	1130	105.02
SUPER BUILT-UP AREA	1410	131.04

FLAT NO. 115 to 515	SFT	SQM
CARPET AREA	775.58	72.08
PLINTH AREA	848	78.81
SUPER BUILT-UP AREA	1060	98.51

FLAT NO. 114 to 514	SFT	SQM
CARPET AREA	784.94	72.95
PLINTH AREA	848	78.81
SUPER BUILT-UP AREA	1060	98.51

FLAT NO. 113 to 513	SFT	SQM
CARPET AREA	990.78	92.08
PLINTH AREA	1110	103.16
SUPER BUILT-UP AREA	1410	131.04

BLOCK - C



EMPOWERED BY SPACES...

Live in a vertical bungalow where your apartment is open on four sides. Enjoy sunrise and sunsets while the large spaces of your home accommodate your whims and fancies of daily living.

FLAT NO. 117 to 517	SFT	SQM
CARPET AREA	1549.22	143.98
PLINTH AREA	1739	161.62
SUPER BUILT-UP AREA	2175	202.14



SPECIFICATIONS

 STRUCTURE RCC framed structure	DINING ROOM: One wash basin(white colour) with pedestal. DADO: Toilets: 6' Height Concept tiles along with matching floor tiles of Johnson make or equivalent (premium quality)	 ELECTRICALS Electrical: White colour modular switches and distribution board. Cables(wiring) of Finolex / Havells make or equivalent Master Bedroom: Two light points (one light point 2-way), one fan point (2-way), one A/c point, four 5A sockets, telephone + TV point (concealed conduit for DTH like Tata Sky) Children Bedroom: Two light points, one fan point, one A/c point, three 5A sockets, telephone Guest Bedroom: Two light points, one fan point, three 5A sockets + A/c point+ telephone point Living Room: Two light points, one fan point, one TV, one telephone and four 5A sockets Foyer: One light point, one socket Dining Room: Two light points, one fan point, one 15A socket for fridge and three 5A sockets Kitchen: Two lights, two 15A sockets and three 5A sockets. One 15A socket for refrigerator Utility: One light point, one 15A (washing machine) Master Bathroom: Two light, one 15A socket for geyser, two 5A sockets Children Bathroom: Two light, one 15A socket for geyser, two 5A sockets Guest Bathroom: Two light points, two 5A sockets, 15A socket for geyser Pooja Room: Two light points, one 5A socket Balcony: One light point, one fan point and 5A socket in each balcony One light point outside entrance door.
 WALLS 4" Internal, 6" & 9" External light weight Red Clay brick masonry		
 PLASTERING Single coat smooth finished cement plastering for inside and double coat smooth finish cement plastering for outside walls	 JOINERY MAIN DOOR: Teak wood frames and Teak wood paneled shutter with designer hardware of reputed make INTERNAL DOORS: Teak wood/ Salwood frames with company made flush shutters with Sun make laminate/ enamel paint on both sides and standard SS hardware WINDOW: UPVC/Powder coated Aluminum window GRILLS: Window grill (MS / Aluminum / SS) will be fixed at inside of the window at extra cost. Balcony enclosures with MS / Aluminum / SS or any other material are not allowed.	
 PAINTING INTERIOR WALLS: One coat of primer and two coats of plastic emulsion paint with smooth luppum finish using reputed brands like Birla, JK White or Laticrete EXTERIOR WALLS: One coat of primer and two coats of Apex or equivalent paint with smooth exterior luppum finish or texture		
 FLOORING Vitrified tiles 2'x2' Johnson / Naveen / Kajaria / Restile / Nitco (premium quality). 2'6"x2'6" Johnson / Naveen / Kajaria / Restile / Nitco (premium quality). Granite / marble or tiles in common areas and staircase. SS railing for staircase	 BACKUP GENERATOR Sound-proof generator, 700W for each flat, including common area, lifts and water pumps (except air conditioners and geysers)	
 TOILETS & ACCESSORIES ALL TOILETS: Hindware/ Parryware/ Jaquar sanitaryware and Jaquar fixtures of Florentine Series. One wall mounted WC (white colour) with flush valve. One wash basin with pillar cock (white colour). One single lever diverter with spout and overhead shower. One health faucet with angle cock.	 KITCHEN SINK 2' Wide black granite kitchen platform. Single bowl stainless steel sink	
	 LIFTS Lifts of standard make(Johnson/Otis)	

Note: 1). All electrical fittings should be purchased by the owner at his own cost, only provision for the above electrical fixtures will be made by the Builder. 2). Shifting of outdoor and indoor A/c units are not allowed. Erection of any type of structures for A/c outdoor unit and others are not allowed. 3). All dimensions indicated are excluding finishes / plastering. Columns and shear walls subject to minor changes based on structural design. 4). Furniture shown are indicative only and do not form the part of the contract. 5). Architectural features shown are indicative and subject to change.

IN THE HEART OF VIZIANAGARAM



EMPOWERED BY CONNECTIVITY...

Feel empowered by your home's connectivity to the best things of life offered by your town. Your home can't get more central than this. Located in the quiet lane of CTO Office, just behind the city centre, **Satya Green Towers** is blissfully close to quality healthcare, star hotels, Railway station and Bus Stand within five minutes distance. A prestigious address and an elite property, Satya Green Towers offers a rare opportunity to own a home that is joy for family and envy for others.

The proposed Bhogapuram International Airport is just 20 Kms away from your home. A joy ride on NH No 5 will take you to the Airport. The proposed Executive State Capital will be built in Bheemli - Madhurawada area bringing the Smart City closer to Vizianagaram. There is never a better time to invest in Vizianagaram than now.



LOCATION MAP (not to scale)



Proposed Bhogapuram Airport



NCS Multiplex & Mall



Tirumala Hospitals



Goddess Paiditali Temple



Railway Station



APSRTC Bus Stand



The Sun School



Corporate College



EMPOWERED BY VALUE AND TRUST...

Satya Builders have been building quality homes for discerning clientele for over a decade in Vizianagaram. Latest designs, superior brands and value for investment are the hallmarks of all their ventures spread in Vizianagaram and Visakhapatnam. Strategic locations, attention to detail, focus on customer aspirations make them the Builder of choice in Vizianagaram.

PROMOTERS



Corporate Office: 60 Feet Main Road, Opp. Satya Green Heights Apartments
Pradeep Nagar, Vizianagaram 535004

Site Address: Lower Tank Bund Road, CTO Office Lane
Near RTC BUS Complex, Vizianagaram

Ph: +91 924 666 7768, 934 644 5777

Email: satya_builders@yahoo.com | www.satyabuilders.in

RERA No: P02280160693

ARCHITECTS



VISTAAS ARCHITECTURAL CONSULTANTS

Mumbai - Hyderabad - Pune - Vizag

www.vac-india.com

STRUCTURAL ENGINEER

Prof. Rambabu, Andhra University
Visakhapatnam

MEP CONSULTANT

PRISM Consulting Engineers
Bengaluru

MEMBER



SOME OF OUR PREVIOUS PROJECTS



Satya Samruddhi



Satya Annapurna Heights



Satya Sadhan



Satya Green Heights



Satya Green County



Satya Usha Grand

NOTE: This brochure is only a conceptual presentation and not a legal offering. The promoters reserve the right to alter and make changes in elevation, highlights, plans and specifications as deemed fit.