

Wake up to a
full bloom and
perfume your
senses!



Green County

Your Home... Your Lifestyle



Green County

Your Home... Your Lifestyle

Home is where love is,
Home is where life is,
Home is where happiness is.

We all know the value of
a home in our lives.
Especially at an age
where we seem to
be swimming in a whirlpool
of our own creation,
home has become all more
important place than ever.

SATYA Builders backed with
rich experience in the field of
construction ably understands
this importance. Located in the
prime land of Vijayanagaram town
Satya's latest project the
GREEN COUNTY is a dwellers paradise.
All the modern amenities and facilities
at this gated community gives
you all the impetus to lead a happy
and blissful life. Come,
be part of a world that has
everything to offer to
make your life wonderful
& more beautiful!



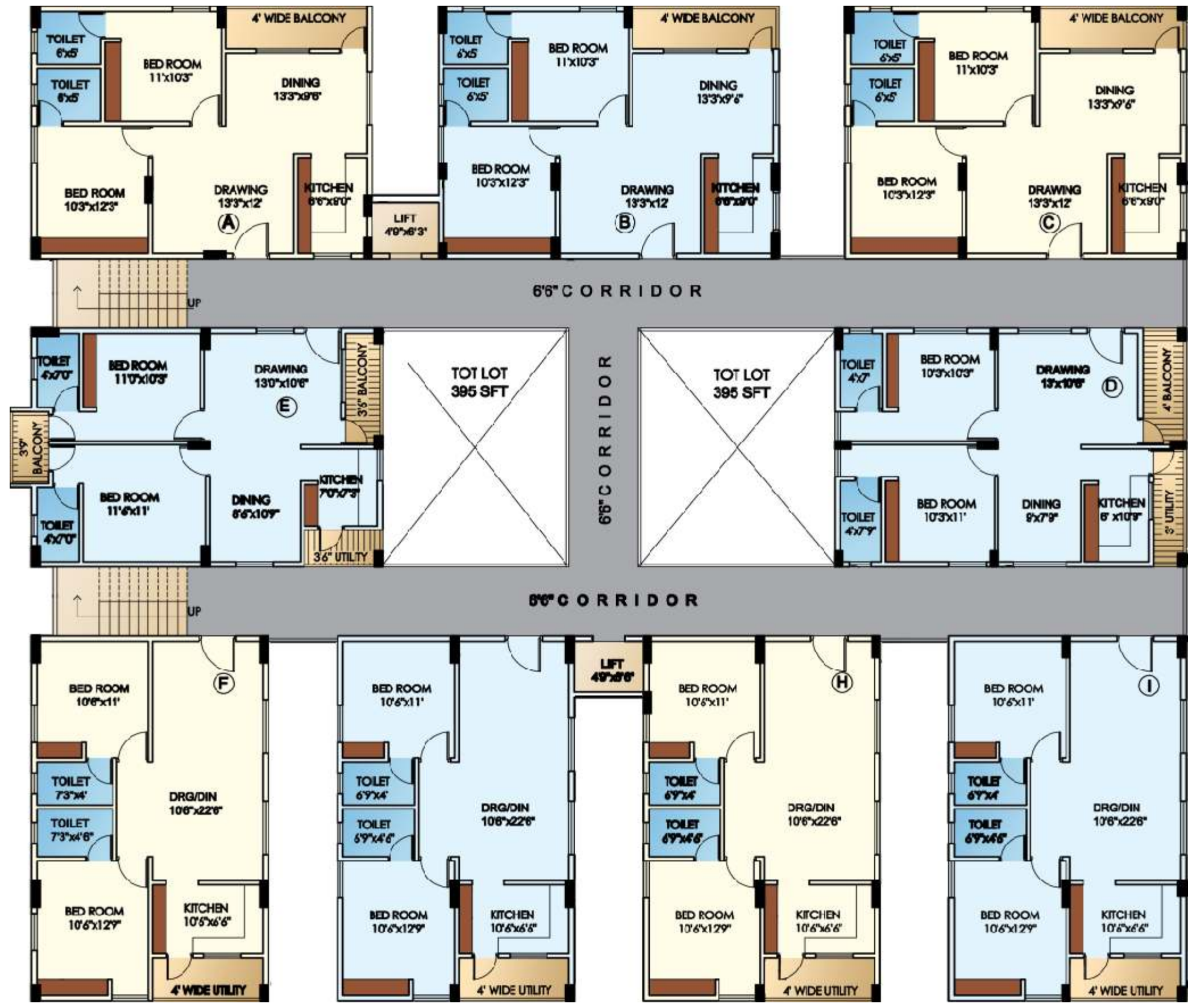

Specifications:

- Structure:** Reinforced cement concrete framed structures.
- Brick Work:** Brick walls with cement mortar 9" thick for external walls and 4 1/2" for internal walls. Smooth finish with cement mortar of plastering.
- Flooring:** Good quality 2'X 2' Vitrified Tiles.
- Wardrobes:** Provision for wardrobes in all rooms, hall & kitchen.
- Doors:** Teak wood frame with teak wood shutters. All other doors with seasoned country wood frames & flush doors.
- Windows:** Well seasoned country wood frames and shutter with safety grills.
- Electrical:** Concealed copper wiring (ISI), Modular Switches adequate points for modern living.
- Kitchen:** Polished Black Granite stone for platform with stainless steel sink and ceramic tiles dadoing up to 2'6" height above platform.
- Toilets:** Glazed ceramic tiles dado up to 5'0" height with concealed piping and Indian/Western comods.
- Sanitary & plumbing:** Plumbing with standards CPVC pipes and UPVC pipe (ISI standards) Lines with quality fittings.
- Painting:** Enamel paint for wood work and grills. Plastic emulsion with smooth finished (putty) for all the internal walls and outside walls with cement based paint.
- Lift:** 2 Lifts of standard make.
- Water:** Overhead storage tank with bore well water.





Green County

Your Home... Your Lifestyle

Features:

As per new G.O. no violation ,
no power problems

Located most prime residential
area with 40'X60' roads

Each flat is independent
without common walls

All flats are designed as per Vasthu

1.5.km from RTC Complex and
2 km from railway station

Proximate distance to schools and colleges

Generator facility for common area lighting, lifts,
2 lights and 2 fan points, 1 tv for each flat.

Intercom from watchman to each flat.

Pleasing elevation and plan designed
and execution by quality conscious
Architects and Engineers.

A children play area.

Good ventilation for all flats.

Registration Charges,
Vat Tax & Service Tax,
Electrical charges are charged extra.
Additional or alternations to the
above specifications will be charged extra.

Green County Route Map

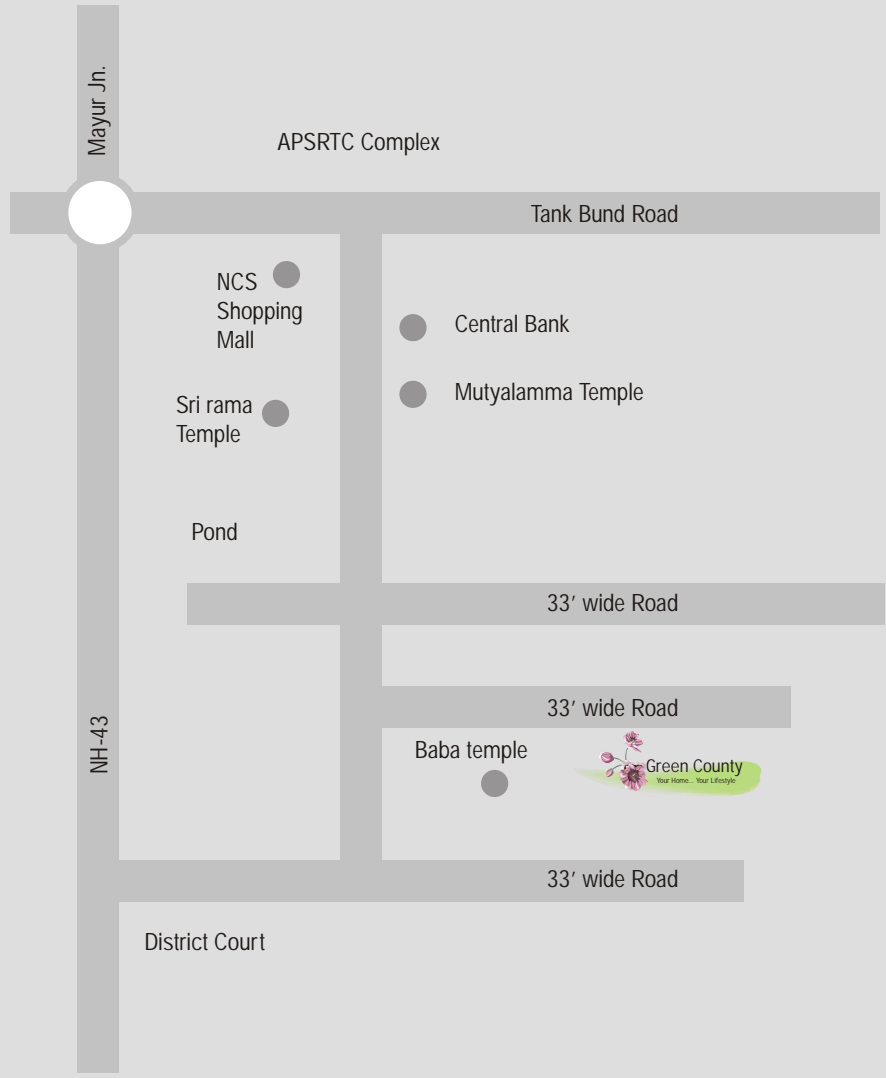

Promoters: 

Logo

Logo

Logo